

Listed on State Register  
VT ACHP  
Date: 5-7-80

STATE OF VERMONT  
Division of Historic Sites  
Montpelier, VT 05602

HISTORIC SITES & STRUCTURES SURVEY  
District ☐ Complex ☒ Survey Form

SURVEY NUMBER: 1105-22		
NEGATIVE FILE NUMBERS: 76-A-90		
UTM REFERENCES		
NW NE SE SW	664240 Easting (farmhouse only)	4824030 Northing
U.S.G.S. QUAD. MAP: Rutland Quad., 7.5' Series		
TYPE OF COMPLEX: Agricultural		
TYPES OF STRUCTURES: Houses, barns		
COMMON NAME: Alfrecha Farm		
PRESENT FORMAL NAME: George Ridlon		
ORIGINAL FORMAL NAME:		
PRESENT USE: Farm (rental)		
ORIGINAL USE: Farm		
ARCHITECT/ENGINEER:		
BUILDER/CONTRACTOR:		
ACCESSIBILITY TO PUBLIC: Yes <input type="checkbox"/> No <input checked="" type="checkbox"/> Restricted <input type="checkbox"/>		

COUNTY:	Rutland
TOWN:	Clarendon
LOCATION:	Middle Road, North Clarendon
PHYSICAL CONDITION OF STRUCTURES:	
Excellent %	Good 100 %
Fair %	Poor %
Deteriorated %	
LEVEL OF SIGNIFICANCE:	
Local <input checked="" type="checkbox"/> State <input checked="" type="checkbox"/> National <input type="checkbox"/>	
THEMES:	
TYPE OF DISTRICT:	
NAME OF DISTRICT:	

(Complex Information Only)

STATEMENT OF SIGNIFICANCE:

The centerpiece and most important structure in this farm complex is a brick, Federal-style farmhouse. The only significant alteration to the original appearance of the house was the replacement of the south parlor windows by longer sash and marble sills and lintels some time in the 19th century. Notable details include the cornice frieze, which is decorated with a gouged circle motif, and fanlit door surround, which has sidelights that extend above the level of the transom bar. The interior is substantially intact.

The original owner of this house is unknown. It was acquired in the 1830's by the Webb family, and was bought at the turn of the 20th century by the Chaffees of Rutland, who operated a creamery and cattle on the property. Most of the outbuildings date from the 20th century.

Reference

Mr. and Mrs. George Ridlon, North Clarendon, Vermont

THREAT TO STRUCTURES:	LOCAL ATTITUDES:
No Threat <input checked="" type="checkbox"/> Zoning <input type="checkbox"/> Roads <input type="checkbox"/>	Positive <input checked="" type="checkbox"/> Negative <input type="checkbox"/> Mixed <input type="checkbox"/>
Development <input type="checkbox"/> Deterioration <input type="checkbox"/>	Other:
Other:	



MAP: (1. Indicate NORTH in circle. 2. Represent each structure as an open box. 3. Number each structure inside of its box.)

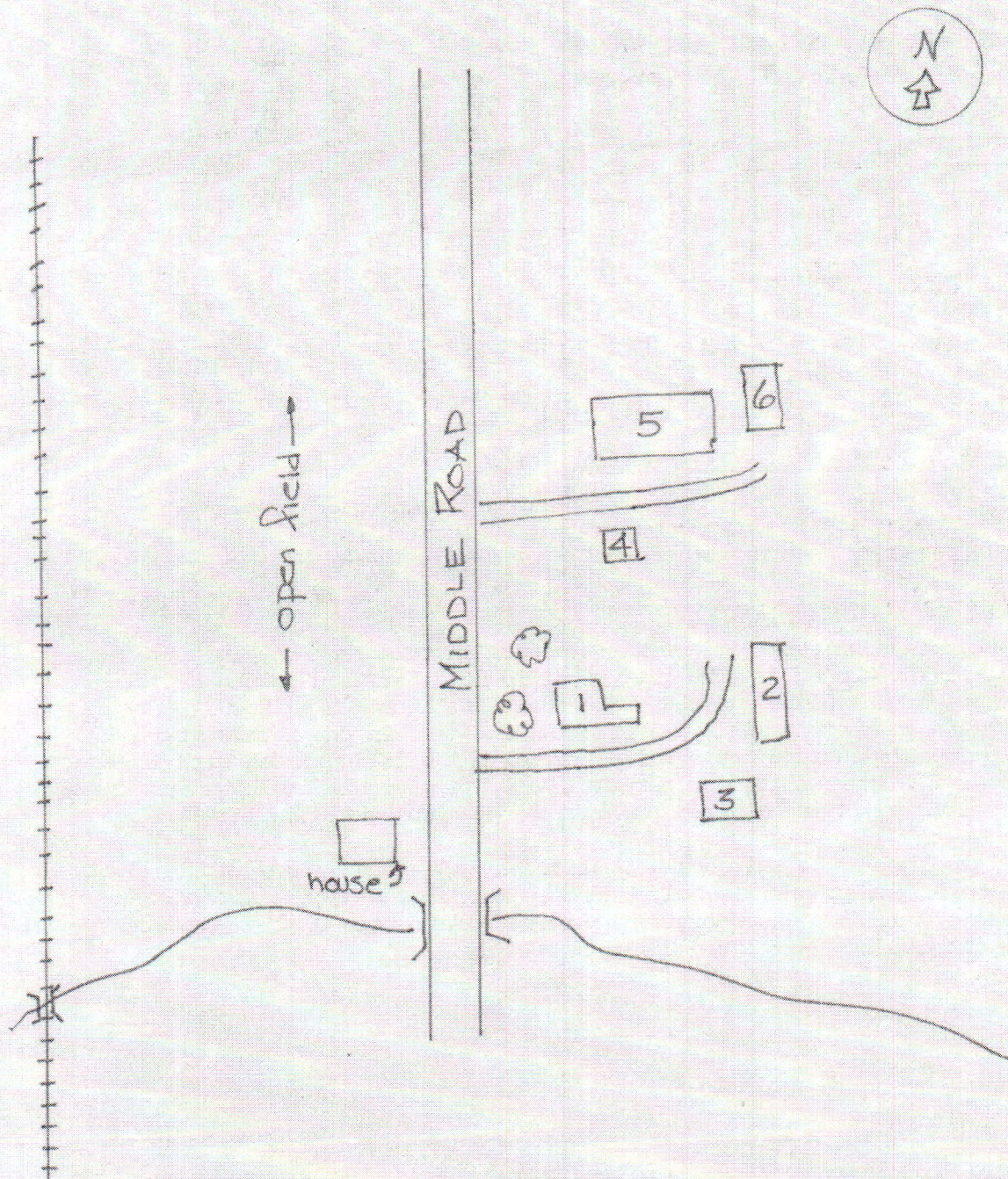

**BOUNDARY DESCRIPTION:**

The boundaries of the complex include all structures and property along both sides of Middle Road owned by George Ridlon.

RECORDED BY:  
Kathlyn Hatch

ORGANIZATION: Vt. Division  
for Historic Preservation

DATE RECORDED:  
5-76



OUTSTANDING COMPONENTS OF DISTRICT <input type="checkbox"/>		COMPLEX <input type="checkbox"/>
(Include individual survey number ONLY if surveyed individually.)		
MAP NUMBER: 1	DATE BUILT: c.1830	SURVEY NUMBER: 1105-22
FUNCTIONAL TYPE: Residential	NEGATIVE FILE NUMBER: 76-A-90	
COMMON NAME: Webb House	OWNER: George Ridlon	
DESCRIPTION: 2½ story, brick Federal style farmhouse. Five-bay facade, two rooms deep. Center entrance with louvered fan over door, sidelights. Gauged, bonded jack arches over windows. Common bond brickwork. Brick ell, with attached sheds.		
MAP NUMBER: 2	DATE BUILT: 20th c.	SURVEY NUMBER: 1105-22
FUNCTIONAL TYPE: Agricultural	NEGATIVE FILE NUMBER:	
COMMON NAME:	OWNER: George Ridlon	
DESCRIPTION: Long, low wood frame shed with a series of arched openings. Used for storage.		
MAP NUMBER: 3	DATE BUILT: 19th c.	SURVEY NUMBER: 1105-22
FUNCTIONAL TYPE: Agricultural	NEGATIVE FILE NUMBER: 76-A-90	
COMMON NAME:	OWNER: George Ridlon	
DESCRIPTION: Two-level, gable-roofed, wood frame horse barn with clapboard siding. Attached sheds.		
MAP NUMBER: 4	DATE BUILT: 1940's	SURVEY NUMBER: 1105-22
FUNCTIONAL TYPE: Residential	NEGATIVE FILE NUMBER:	
COMMON NAME:	OWNER: George Ridlon	
DESCRIPTION: 1½ story, L-plan, shingled bungalow. Incorporates part of the old Chaffee creamery erected in the early 20th century.		
MAP NUMBER: 5	DATE BUILT: 20th c.	SURVEY NUMBER: 1105-22
FUNCTIONAL TYPE: Agricultural	NEGATIVE FILE NUMBER:	
COMMON NAME:	OWNER: George Ridlon	
DESCRIPTION: Large, wood frame dairy barn with gambrel roof and vertical plank siding.		
MAP NUMBER: 6	DATE BUILT: recently	SURVEY NUMBER: 1105-22
FUNCTIONAL TYPE: Agricultural	NEGATIVE FILE NUMBER:	
COMMON NAME:	OWNER: George Ridlon	
DESCRIPTION: Long, narrow, one-level, wood frame building used for storage and as a garage.		
MAP NUMBER:	DATE BUILT:	SURVEY NUMBER:
FUNCTIONAL TYPE:	NEGATIVE FILE NUMBER:	
COMMON NAME:	OWNER:	
DESCRIPTION:		
MAP NUMBER:	DATE BUILT:	SURVEY NUMBER:
FUNCTIONAL TYPE:	NEGATIVE FILE NUMBER:	
COMMON NAME:	OWNER:	
DESCRIPTION:		